

1 BACK VIEW  
SCALE: 1" = 1'-0"

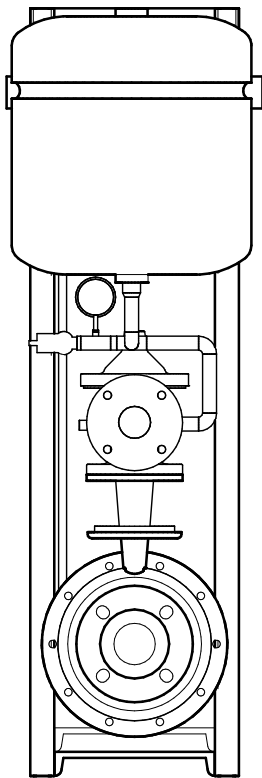

2 FRONT VIEW  
SCALE: 1" = 1'-0"

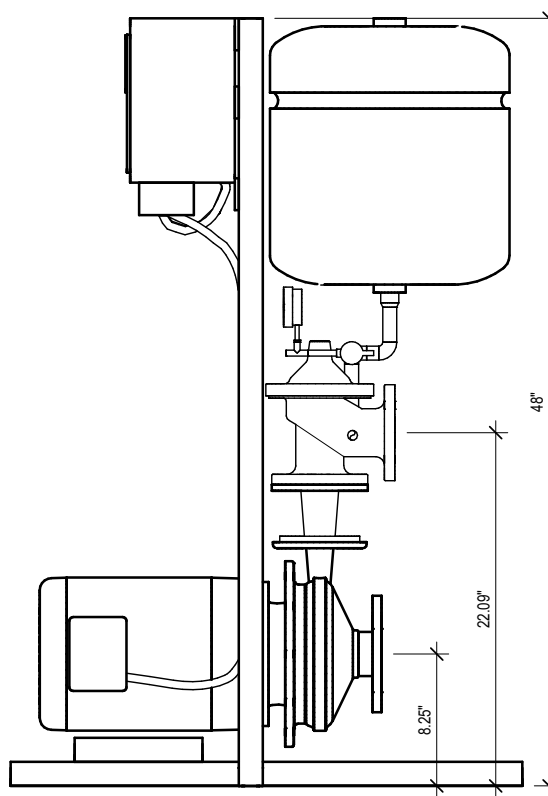

3 SIDE VIEW  
SCALE: 1" = 1'-0"

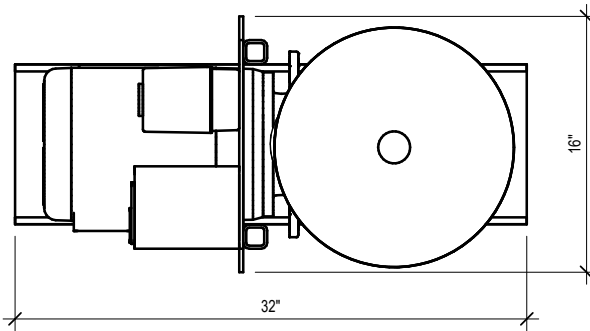

4 PLAN VIEW  
SCALE: 1" = 1'-0"

### WATER PRESSURE BOOSTER SYSTEM

SERIES: POSI-BOOST MODULAR WATER PRESSURE BOOSTER SYSTEM  
NOMINAL WEIGHT: 225LBS

MANUFACTURER	MODEL NUMBER	GPM	TDH	HP	RPM
PENN PUMP CO	PB-1000	-	-	10	3600

### BILL OF MATERIAL

ITEM NO.	DESCRIPTION	QUANTITY
1	STAINLESS STEEL END SUCTION PUMP - 10HP	1
2	IQ VFD CONTROLLER - 10HP	1
3	NEMA 4X DISCONNECT SWITCH	1
4	2" ANGLE CHECK VALVE	1
5	4-20MA, 0-200PSI TRANSDUCER	1
6	0-160PSI PRESSURE GAUGE	1
7	THERMAL PURGE VALVE - SET TO 105°F	1
8	PRESSURE RELIEF VALVE - SET TO 125PSI	1
9	10 GALLON HYDROPNEUMATIC TANK - 150PSI RATED	1

### FIELD CONNECTIONS

ITEM NO.	DESCRIPTION	QUANTITY
A	SUCTION CONNECTION - 2.5" 150LBS RF	1
B	DISCHARGE CONNECTION - 2" 150LBS RF	1
C	PRESSURE RELIEF VALVE - 3/4" NPT	1
D	THERMAL PURGE VALVE - 1/4" NPT	1
E	ELECTRICAL CONNECTION - VARIES	1

### GENERAL NOTES:

- FACTORY TEST AND PAINT WITH TWO COATS OF SHOP ENAMEL
- SYSTEM DRAIN AND VENT CONNECTIONS AS REQUIRED
- SYSTEM FLEXIBLE CONNECTORS SHIP LOOSE WHEN PURCHASED WITH SYSTEM
- NOT FOR CONSTRUCTION PURPOSES UNLESS CERTIFIED

REV	DESCRIPTION	DATE	APPROVED

<b>PENN</b> <b>PUMP</b> & EQUIPMENT COMPANY, INC.	DRAWN BY: _____ DATE: 11/19/2021 CHECKED BY: B-CAD DATE: 11/19/2021 ISSUE DATE: DC DATE: 11/19/2021	<b>POSI-BOOST</b> <b>10HP BOOSTER SYSTEM</b>	
	APPROVED BY: _____ DATE: 11/19/2021 SCALE: NONE	SIZE: A FSCM NO.: _____ DWG NO.: _____ SHEET 1 OF 1	REV: 0